

CPU HOLDER: CPU13-25
Wall Mount / Under desk Mount

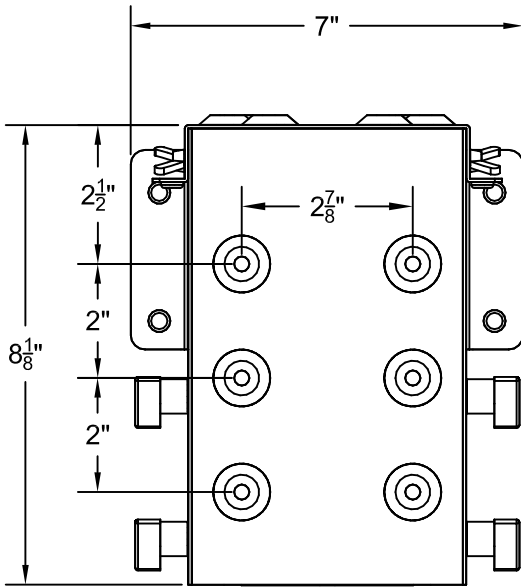

TOP VIEW

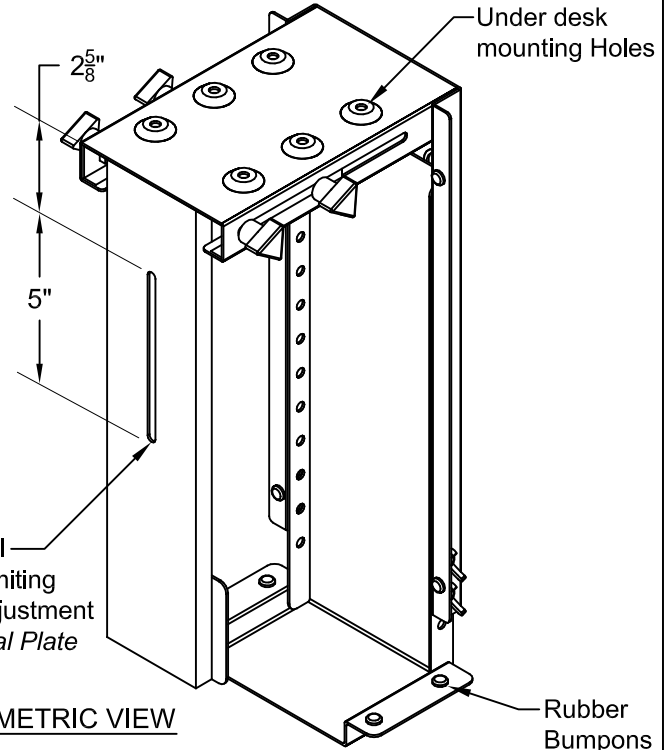

ISOMETRIC VIEW

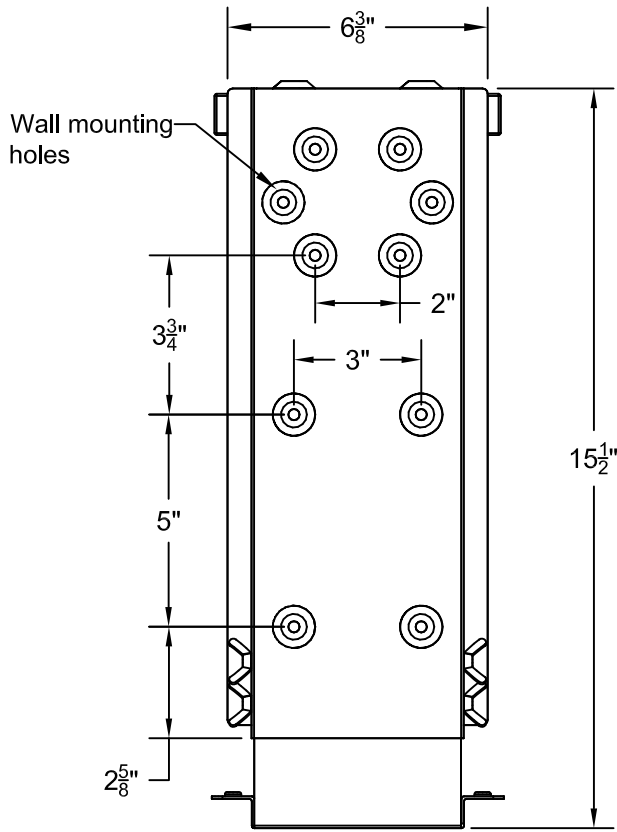

BACK VIEW
Mounting Hole Pattern

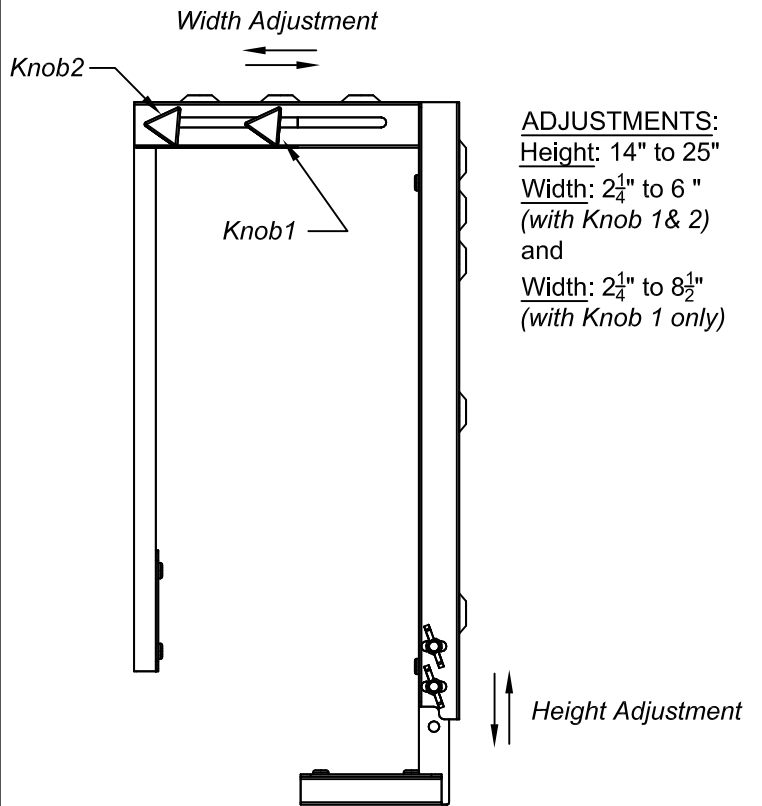

SIDE VIEW

ADJUSTMENTS:
Height: 14" to 25"
Width: 2 1/4" to 6" (with Knob 1 & 2) and
Width: 2 1/4" to 8 1/2" (with Knob 1 only)

MATERIAL :	DRAWN BY : PR	DATE: 01/27/11	DESCRIPTION :
	A P P R O V E D		CPU HOLDER
TOLERANCES UNLESS OTHERWISE SPECIFIED FRACTIONAL ±1/64 2 PLC. DEC. ±.01 3PLC. DEC. ±.001 ANGULAR ±.5° FINISH √	ENG :		USED ON :
	MFG :		PATH : Accessories/CPU Holder/CPU13-25
	QA :		NUMBER : CPU13-25_01
	SCALE: N.T.S.	SHEET : 1 OF 1	LAYER :